

## KPUOR 70

### Description

Product group	Piston seal
Design	PUOR TPU seal with an o-ring energising element
Profile no.	70
Specification	Z suitable for two- sided pressure load
Seal material	TPU 95 3001
O-ring material	NBR 70 0100

### Operational application limits

Pressure (MPa):	≤25
Temperature (°C):	-30 to +100
Running speed (m/s):	≤0.5

### Media

Hydraulic oils acc. to DIN 51524  
Part 1 – 3, lubricating oils, mineral oil  
based lubricating greases, highly non-  
flammable hydraulic fluids HFA, HFB,  
HFC acc. to VDMA 24317

### Function

The double-acting KPUOR 70 seal  
consists of a TPU sealing element  
which is energised by an o-ring.  
This results in an exceptionally good  
sealing function with heavy loads and  
good static sealing performance. The  
sealing performance is significantly  
better due to the TPU material than with  
comparable PTFE seals.

### Installation

This seal can generally be installed in  
cut grooves without calibration which  
makes the KPUOR 70 design very easy  
to install.

### Remarks

The KPUOR 70 design combines the  
robustness of TPU with the advantage  
of very small, installation friendly  
 housings. For special applications, the  
hardness of the o-ring or the material  
can be changed. The seal is used  
particularly in agricultural machines,  
mobile hydraulic platforms, ground  
conveyors and standard cylinders.

### Order code

Please include our item numbers in  
your order. Should you require non-  
standard dimensions, materials or  
material combinations, please use the  
order code on page 12.

### Any seal. Any time.

All the items in our standard programme  
(marked red) are standard stock items.  
For all other items, please check the  
availability at [www.dichtomatik.de](http://www.dichtomatik.de).

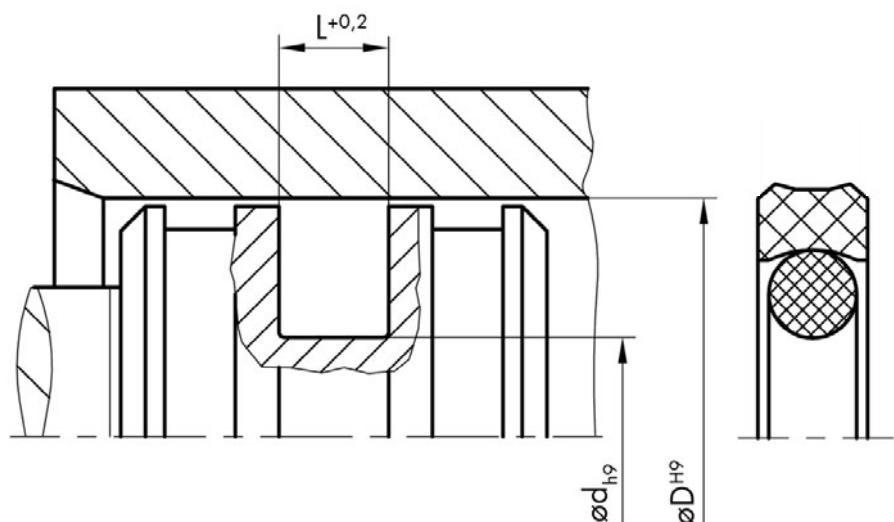

**KPUOR 70****Sizes**

Item No.	Code	D	d	L
174092	KPUOR 70 Z	15	7.5	3.2
161246	KPUOR 70 Z	16	8.5	3.2
174093	KPUOR 70 Z	20	12.5	3.2
174094	KPUOR 70 Z	22	14.5	3.2
161231	KPUOR 70 Z	25	14	4.2
174095	KPUOR 70 Z	25	17.5	3.2
161232	KPUOR 70 Z	30	22.5	3.2
161233	KPUOR 70 Z	32	21	4.2
174096	KPUOR 70 Z	32	24.5	3.2
174097	KPUOR 70 Z	35	27.5	3.2
174098	KPUOR 70 Z	40	24.5	6.3
161234	KPUOR 70 Z	40	29	4.2
174099	KPUOR 70 Z	40	32.5	3.2
174100	KPUOR 70 Z	45	29.5	6.3
174101	KPUOR 70 Z	45	34	4.2
174102	KPUOR 70 Z	48	37	4.2
174103	KPUOR 70 Z	49	38	4.2
174104	KPUOR 70 Z	50	34.5	6.3
161235	KPUOR 70 Z	50	39	4.2
174105	KPUOR 70 Z	52	36.5	6.3
174106	KPUOR 70 Z	54	43	4.2
174107	KPUOR 70 Z	55	39.5	6.3
174108	KPUOR 70 Z	55	44	4.2
174109	KPUOR 70 Z	60	44.5	6.3
161236	KPUOR 70 Z	60	49	4.2
174110	KPUOR 70 Z	63	47.5	6.3
161237	KPUOR 70 Z	63	52	4.2
174111	KPUOR 70 Z	63.5	52.5	4.2
174112	KPUOR 70 Z	65	49.5	6.3
174113	KPUOR 70 Z	65	54	4.2
174114	KPUOR 70 Z	70	54.5	6.3
161238	KPUOR 70 Z	70	59	4.2
174115	KPUOR 70 Z	75	59.5	6.3
174116	KPUOR 70 Z	75	64	4.2
161239	KPUOR 70 Z	80	64.5	6.3
161240	KPUOR 70 Z	80	69	4.2
174117	KPUOR 70 Z	85	69.5	6.3
158782	KPUOR 70 Z	90	74.5	6.3
174118	KPUOR 70 Z	95	79.5	6.3
161241	KPUOR 70 Z	100	84.5	6.3
174119	KPUOR 70 Z	105	89.5	6.3
161242	KPUOR 70 Z	110	94.5	6.3
174120	KPUOR 70 Z	115	99.5	6.3
161243	KPUOR 70 Z	120	104.5	6.3
174121	KPUOR 70 Z	125	104	8.1
161244	KPUOR 70 Z	125	109.5	6.3
161245	KPUOR 70 Z	130	114.5	6.3
174122	KPUOR 70 Z	135	114	8.1
174123	KPUOR 70 Z	140	119	8.1
174124	KPUOR 70 Z	150	129	8.1
174125	KPUOR 70 Z	160	139	8.1
174126	KPUOR 70 Z	170	149	8.1
174127	KPUOR 70 Z	180	159	8.1
174128	KPUOR 70 Z	200	179	8.1
174129	KPUOR 70 Z	250	229	8.1