

ADM 55

Description

Product group	Wiper
Design	DM Double wiper, with metal bonded fit
Profile no.	55
Material	TPU 95 3401, steel acc. to DIN EN 10139

Operational application limits

Temperature (°C): -40 to +100
Running speed (m/s): ≤ 1

Media

Hydraulic oils acc. to DIN 51524 Part 1 - 3, lubricating oils, mineral oil based lubricating greases, highly non-flammable hydraulic fluids HFA, HFB, HFC acc. to VDMA 24317

Function

The ADM 55 is a double-acting wiper. It provides a double function wiping the dirt from the rod and retaining the residue oil film with the second lip. The retained oil can be returned to the system through a leakage bore hole. On the outer circumference, a metal caged ring is vulcanised onto the TPU body.

Installation

Wipers of the ADM 55 design can be installed in an axially accessible installation housing. The advantage lies in the simple design of the installation housing and practical easy installation, in particular with smaller diameters. Please note that the installation housing has to be designed with light chamfering (see table page 8).

Remarks

Wipers made of TPU are well suited for applications in mobile hydraulic systems which are subjected to a heavy dirt load. Due to the good wear resistance of Polyurethane, the ADM 55 has a long service life. The metal angle ring ensures the functionally correct fit of the wiper in the installation housing due to a press fit allowance. The design of the metal angle ring leaves only a small surface area open to attack by corrosive media.

Order code

Please include our item numbers in your order. Should you require non-standard dimensions, materials or material combinations, please use the order code on page 12.

Any seal. Any time.

All the items in our standard programme (marked red) are standard stock items. For all other items, please check the availability at www.dichtomatik.de.

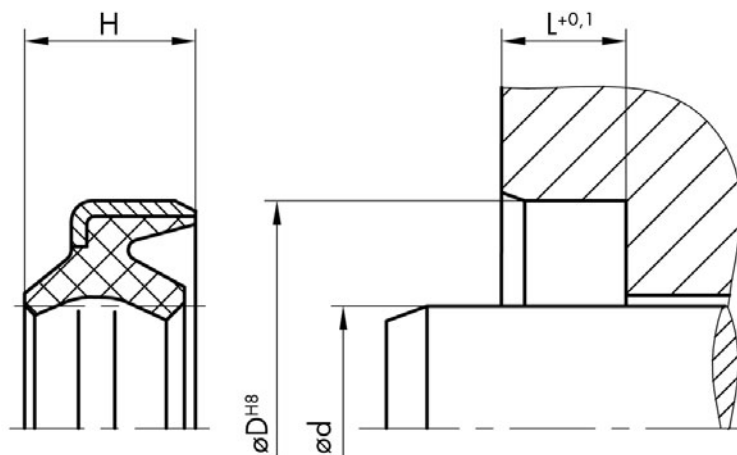

ADM 55**Sizes**

Item No.	Code	d	D	H	L
143435	ADM 55	19	26	7	5
133260	ADM 55	19	27	6	4
117909	ADM 55	20	32	9	6
117919	ADM 55	25	37	9	6
117920	ADM 55	30	42	9	6
117921	ADM 55	32	44	10	7
135031	ADM 55	32	52	11	8
117922	ADM 55	34	46	10	7
117923	ADM 55	35	47	10	7
135033	ADM 55	36	48	10	7
117924	ADM 55	38	50	10	7
117925	ADM 55	40	52	10	7
117926	ADM 55	45	57	10	7
117927	ADM 55	50	62	10	7
135032	ADM 55	50	72	10	8
117928	ADM 55	55	69	11	8
117929	ADM 55	60	74	11	8
117930	ADM 55	65	79	11	8
155671	ADM 55	70	83	11	8
117931	ADM 55	70	84	11	8
117932	ADM 55	75	89	11	8
117933	ADM 55	80	94	12	8
117934	ADM 55	85	99	11	8
117935	ADM 55	90	104	11	8
117936	ADM 55	95	109	11	8
117937	ADM 55	100	114	11	8
117938	ADM 55	105	121	12	9
117939	ADM 55	110	126	12	9
117940	ADM 55	115	131	12	9
117941	ADM 55	120	136	12	9
117942	ADM 55	130	146	12	9
117943	ADM 55	140	160	14	10